

GRAPHISOFT®
ARCHICAD



ARCHICAD is BIM

ARCHICAD® is the leading Building Information Modeling (BIM) software solution for the architecture and design industry.

Work in 3D: All creative work and design documentation happens in 3D, so you can make design decisions and see the results in a project's real, 3D environment.

One, central model: Designers work on a single building model to create, document, and construct their ideas – changes are fast and automatic.

Documentation made easy: Automatically updated, one-click documentation makes even the most tedious tasks fast and easy.

BIM for Architects

ARCHICAD's focus on architecture, design, and creativity, combined with cutting-edge technology and innovation, allows architects to do what they do best: design great buildings.

Developed by architects for architects: ARCHICAD's focus on architecture, backed by more than 30 years of experience and innovation, is evident in millions of buildings worldwide.

Dedicated tools: ARCHICAD's focus on architects ensures that the design workflows and collaboration tools serve their needs from the first sketch through the full life-cycle of the building.

Your platform, your choice: ARCHICAD was the first architectural design software available for both the Microsoft Windows and Apple Macintosh operating systems – innovations for the iOS and Android platforms ensure seamless design and collaboration among all project stakeholders.

Intuitive BIM

With its architect-inspired toolset, ARCHICAD feels like the most natural BIM application on the market.

Smart tools: Throughout the years, ARCHICAD has advanced not only in areas such as design workflow, but also in the details – providing intuitive tools not instantly visible, but at your fingertips when you need them.

Graphic user interface: ARCHICAD's user interface is a true reflection of the architect at work – options and commands mirror those used in an architectural practice.

3D editing and manipulation: ARCHICAD was the first in BIM to allow architects to create, edit, and modify their designs in their natural, 3D environment – all changes are made automatically and in all corresponding views.

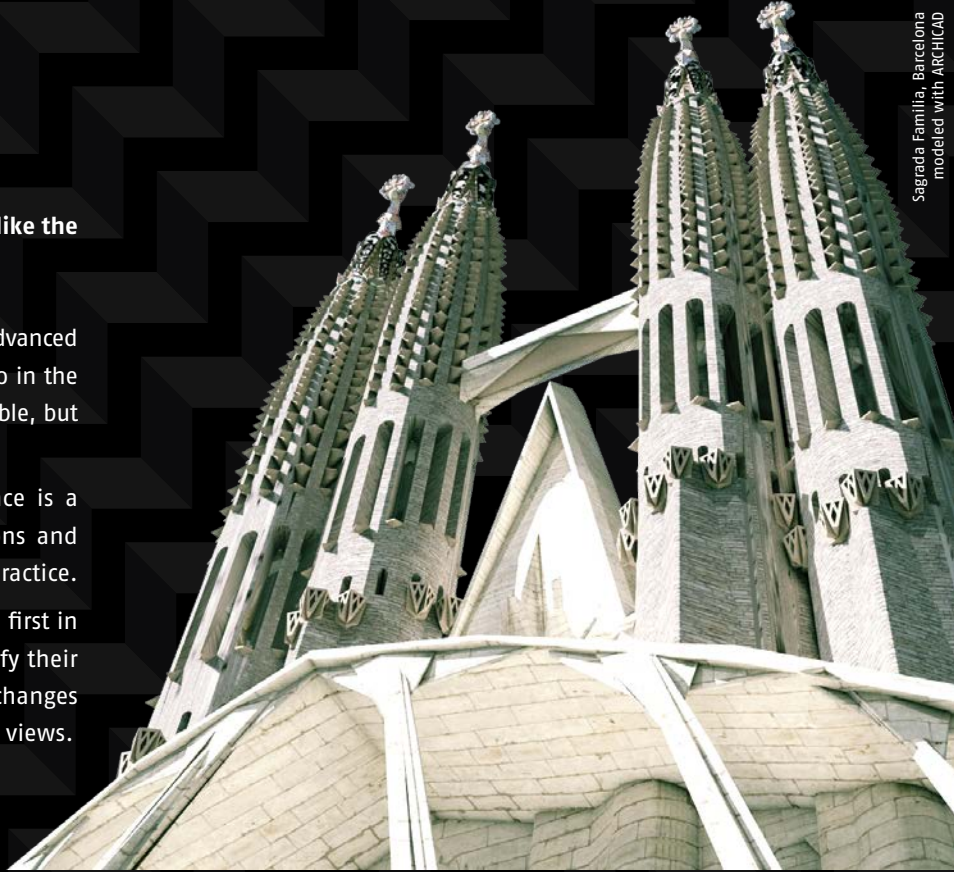

Sagrada Família, Barcelona
modeled with ARCHICAD



ARCHICAD is Local

Available in 17 languages and 27 localized versions that meet local layout and documentation standards, ARCHICAD offers much more than just a simple translation of the software.

Local content and standards: localized library parts, measurement units, and architectural standards are just some of the details that make ARCHICAD ready-to-use in your market.

Local support: GRAPHISOFT's worldwide technical support network ensures you'll get the help you need – when you need it.

Add-ons as you need them: ARCHICAD's application programming interface enables third party developers to extend the functionality of the software when necessary.

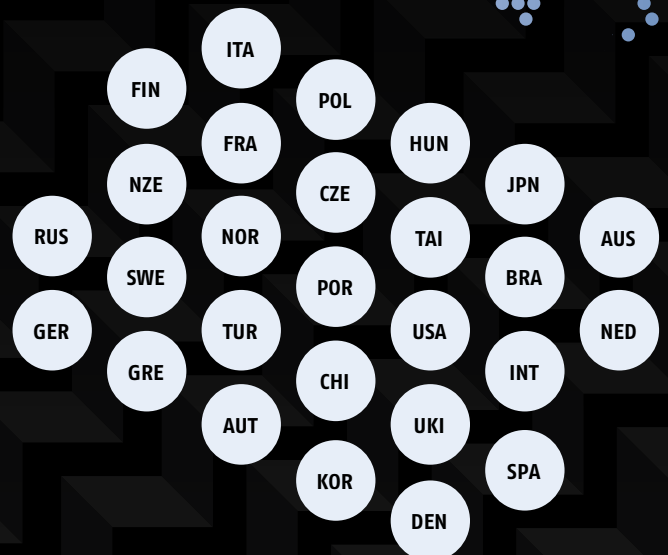

Design in BIM

ARCHICAD offers architects the tools they need to unleash their inner creative genius.

Conceptual design: Intuitive tools help create conceptual models, automatically calculating floor area as you work.

Design freedom: ARCHICAD's innovative tool-set allows you to create your model in the BIM environment – your cool shapes and forms will automatically generate elevations, sections, and even schedules.

Algorithmic design: Freeform and parametric design are at your fingertips with the first, bi-directional connection allowing architects and designers to use Grasshopper with ARCHICAD.

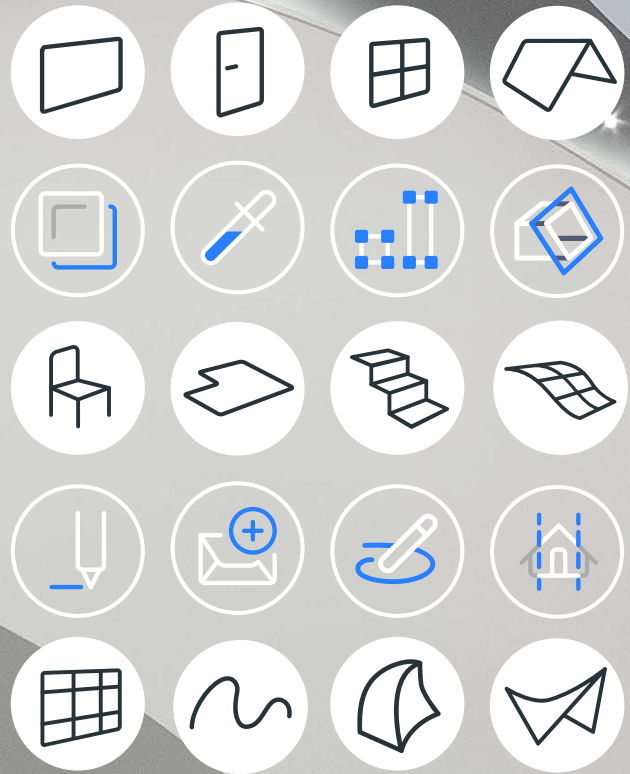

BIM Performance

No more waiting for views to load. Lightning-fast response times makes ARCHICAD the undisputed speed leader in the BIM business.

Large, complex models: Working on extra-large and complex models is no problem for ARCHICAD, which effectively uses all the RAM your computer has.

Instant model updates: ARCHICAD's Predictive Background Processing feature takes advantage of unused computer capacity by anticipating what you might do next and preparing for it in the background.

Smooth 3D navigation: By optimizing OpenGL, ARCHICAD ensures smooth and lightning-fast navigation – even on extremely large building models.

BIM Visualization

Whether you want still images, animations, or interactive Hyper-models, ARCHICAD provides professional, out-of-the-box solutions for all your presentation needs.

Photo-realistic renderings: Built-in sketch rendering and MAXON's CineRender are fast and easy-to-use, producing outstanding images for your client presentations.

Photo-realistic animations: Create even more lifelike presentations by connecting your rendered images with a camera path, resulting in animations.

Interactive models (BIMx): Create a fully-interactive design presentation package that runs on mobile devices and can be viewed by all the project stakeholders.

One-click Documentation

One click is all it takes to ensure that construction documentation is a standard function of the design process.

Automatic drawing generation: Building views, sections, elevations, interior elevations and 3D documents are all derived from the Building Information Model and updated automatically.

Coordinated drawings: Detail drawings are created automatically from the Building Information Model, while additional information can be added – layouts and naming are automatic and coordinated.

Publishing and revision management: One-click publishing and state-of-the-art revision management support teams working on large projects using various file formats.

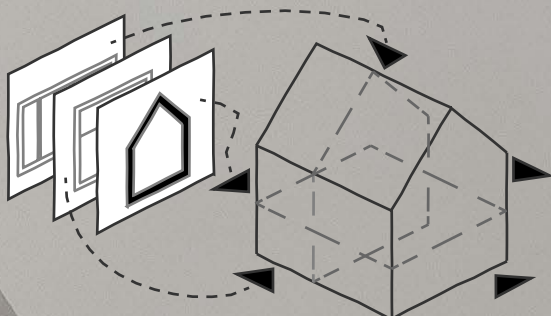

The 'I' in BIM

Leveraging well-structured information results in enormous efficiencies in the construction industry.

IFC is the only open and standard 3D object-oriented exchange format used in BIM software. BCF-based data exchange is particularly suited for identifying overlaps when several models from different applications are combined in one program. ARCHICAD directly supports both standards.

COBie is an international standard relating to managed asset information including space and equipment. The inventor of COBie has confirmed that ARCHICAD is 100% COBie-compliant.

Full building life-cycle: ARCHICAD's central BIM database enables you to collect, edit, and maintain information about a building from the first sketch, meetings with external consultants and engineers, through the building phase and beyond – providing an invaluable asset for building management and maintenance.

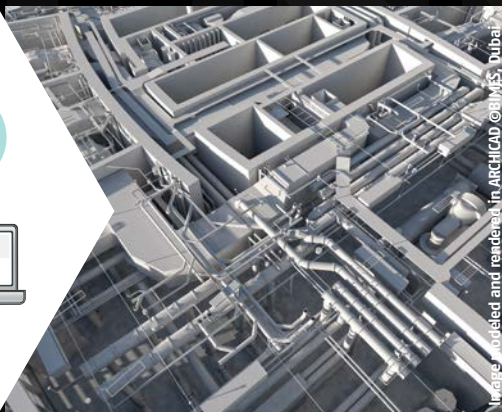
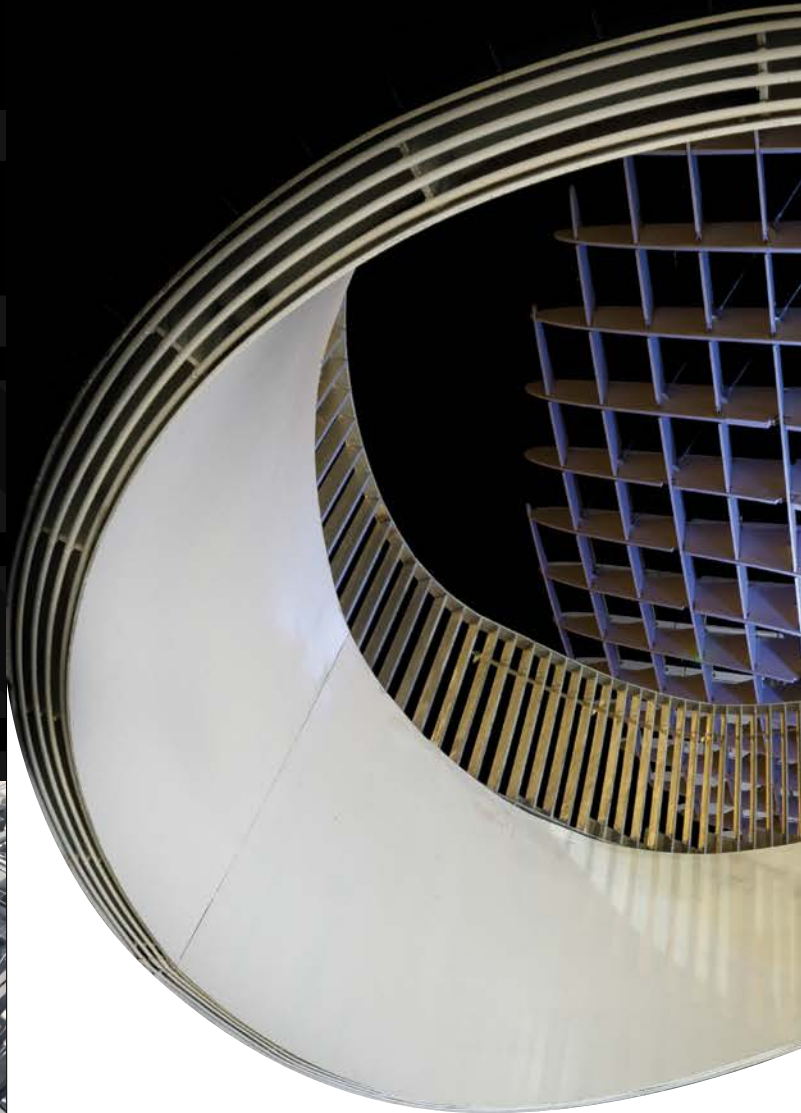

Image modeled and rendered in ARCHICAD © Graphisoft, Dubai



Teamwork

ARCHICAD's award-winning Teamwork concept has changed the way architects collaborate, with Cloud-based BIM collaboration and mobile messaging.

Teamwork: Architects can choose to work offline or in real-time, sending and receiving changes that are made in the blink of an eye.

BIM in the Cloud: ARCHICAD's BIMcloud works on any network, hardware or software configuration, connecting teams and projects of any size or setup.

NextGen collaboration: ARCHICAD leverages the latest trends, allowing architects to share and collaborate on projects using the full range of hardware, tablets, and smartphones.

Construction Coordination

Model-based analysis ensures that you'll catch those design problems that could cause construction issues down the line.

Constructability checking: With a single mouse click, the Solibri Model Checker analyzes the building information model and reveals potential flaws and weaknesses in the design, highlights the clashing components, and checks that the model complies with BIM requirements and best practices.

Collision detection: Available for all ARCHICAD users, this integrated feature allows two groups of elements to be compared through user-defined criteria sets, helping architects discover potential issues now, avoiding construction problems later.

Energy analysis: ARCHICAD's commitment to energy conservation means you'll get accurate feedback about your building design's energy consumption every step of the way.

AEC Collaboration

ARCHICAD is a founder of the OPEN BIM approach to collaborative design, construction, and operation of buildings based on open standards and workflows.

The OPEN Collaboration Approach elevates the conversation from the data level to the workflow level making data what it is: a vehicle of high-level information. As a result, project participants can be selected based upon their professional expertise and not what software they use.

Interdisciplinary Collaboration: ARCHICAD supports easy and effective collaboration between architects and engineers with flexible element filtering and classification features and support for reference model and change management workflows.

Architectural Collaboration: ARCHICAD's Teamwork and file hotlinking solutions offer quick fixes for in-house or remote architectural collaboration. The OPEN BIM workflows make collaboration possible between architectural firms using different BIM or flatCAD software.



OPEN BIM™

BENTLEY® AECOSIM

REVIT® STRUCTURE

ALLPLAN®
ENGINEERING

ALLPLAN® PRECAST

ENERGYPLUS™

AUTOCAD® MEP

TEKLA® STRUCTURES

SOLIBRI®
MODEL CHECKER

REVIT® MEP

DLUBAL RFEM

NAVISWORKS®

DDS-CAD MEP

ETABS®

TEKLA® BIMSIGHT

PLANCAL NOVA

SCIA ENGINEER



MORE THAN

180

APPLICATIONS
SUPPORT IFC

GRAPHISOFT®

A NEMETSCHKE COMPANY

For more details, contact any GRAPHISOFT office
or visit: www.graphisoft.com/archicad/

 **Brasil**

GRAPHISOFT Brasil
Phone: +55 11 3045 4350
E-mail: brasil@graphisoft.com
Web: www.graphisoft.com/br

 **Russia & CIS**

GRAPHISOFT Representative Office
Phone: +7 495 510 2503
E-mail: russia@graphisoft.com
Web: www.graphisoft.ru

 **China**

GRAPHISOFT Beijing Rep. Office
Phone: +86 10 6310 2808
E-mail: mail@graphisoft.cn
Web: www.graphisoft.cn

 **Singapore**

GRAPHISOFT Singapore
Phone: +65 6710 7720
E-mail: mail@graphisoft.sg
Web: www.graphisoft.sg

 **Germany**,  **Austria**

GRAPHISOFT Deutschland GmbH
Phone: +49 89 746 430
E-mail: mail@graphisoft.de
Web: www.graphisoft.de

 **Southeast Asia**

GRAPHISOFT Asia Ltd.
Phone: +852 3975 3260
E-mail: mail@graphisoft.hk
Web: www.graphisoft.hk

 **Italy**

GRAPHISOFT Italy
Phone: +39 041 894 3500
E-mail: italia@graphisoft.com
Web: www.graphisoft.com/it

 **United Kingdom**

GRAPHISOFT UK Ltd.
Phone: +44 1895 527 590
E-mail: sales@graphisoft.co.uk
Web: www.graphisoft.co.uk

 **Japan**

GRAPHISOFT Japan Co., Ltd.
Phone: +81 3 55 45 3800
E-mail: info@graphisoft.co.jp
Web: www.graphisoft.co.jp

 **United States**,  **Canada**

GRAPHISOFT North America, Inc.
Phone: +1 617 485 4200
E-mail: info@graphisoft.com
Web: www.graphisoft.com

 **Mexico & Latin America**

GRAPHISOFT Mexico
Phone +52 5687 1460
E-mail: info@graphisoft.mx
Web: www.graphisoft.mx

Image Credits: Charles Perkins Centre, Australia
fjmt | francis-jones morehen thorp - <https://fjmtstudio.com>
Photo © Keira Yang Zhang

GRAPHISOFT, ARCHICAD, BIMx, BIMcloud are registered trademarks of GRAPHISOFT SE.
Other names may be trademarks of their respective owners.